

#### 4 SETUP FOR A MOBILE STAND CONFIGURATION

A. Insert the tablet into the Mobile Stand by aligning the Stand's Dock Connector with the Tablet's Dock Connector.

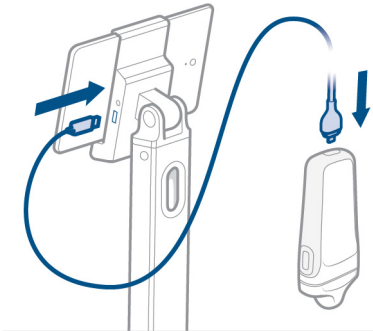

B. Connect the Cable to the Probe and Stand.

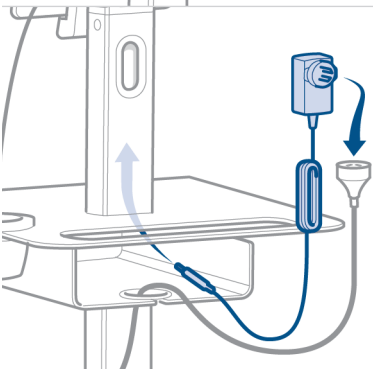

C. Install the DC Power Supply into the Mobile Stand.

Note: If required install a multiple socket outlet or a medical grade extension cable.

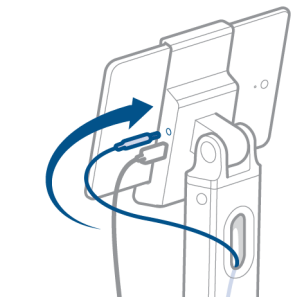

D. Plug the DC Power Supply into the Mobile Stand.

E. Plug the system into an AC socket to fully charge.

Note: To add a wireless printer, please refer to the User Manual.



Refer to user manual before use.

Caution: Federal (USA) law restricts this device to sale by or on the order of a physician.

The Uscan is for non-invasive imaging of the human body and is intended for the following applications: Abdominal, Musculoskeletal, Pediatric, and Small Organ. Users must have ultrasound training for abdominal, musculoskeletal, pediatric, and small organ imaging.

The Uscan can also be used to obtain an image of the bladder that is used to automatically determine bladder volume.

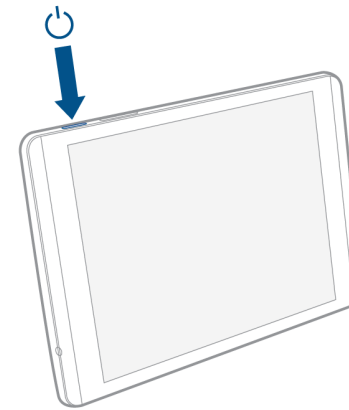

#### 1 TURN THE TABLET ON

Press and hold the Power Button for about 2 seconds to turn the tablet on.



#### 2 CONFIGURING THE TABLET AND REGISTRATION

Follow the on-screen setup wizard to configure the tablet.

- Select Language.
- Setup Date and Time.
- Optional (Connect to Wi-Fi). Note: A Wi-Fi connection is required for automatic registration and activation of the system.
- Enter Registration Information.



**3**  
**SETUP FOR A MOBILE HAND  
CARRIED CONFIGURATION**

A. Insert the tablet into the tablet cover.

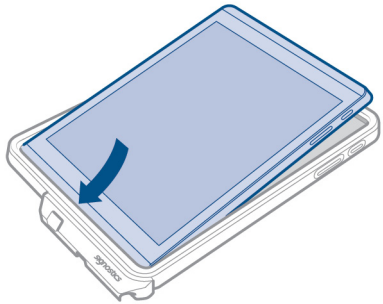

B. Connect the cable to the probe.

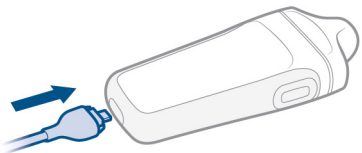

C. Connect the cable from the probe to the Tablet.



D. Route the cable through the retention clip and press into place.

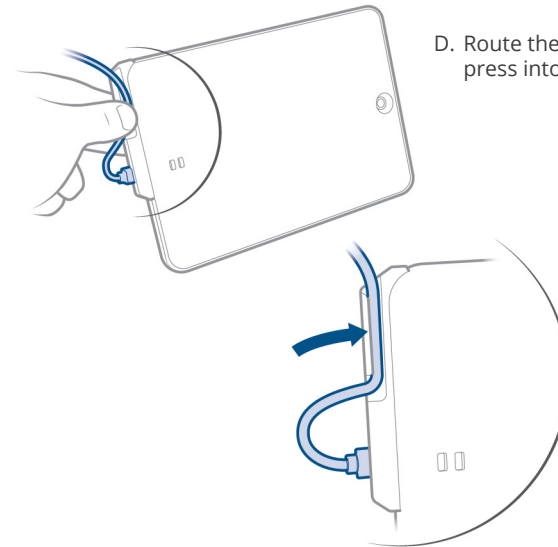

E. Fully charge the system by connecting the charger to the tablet.

